

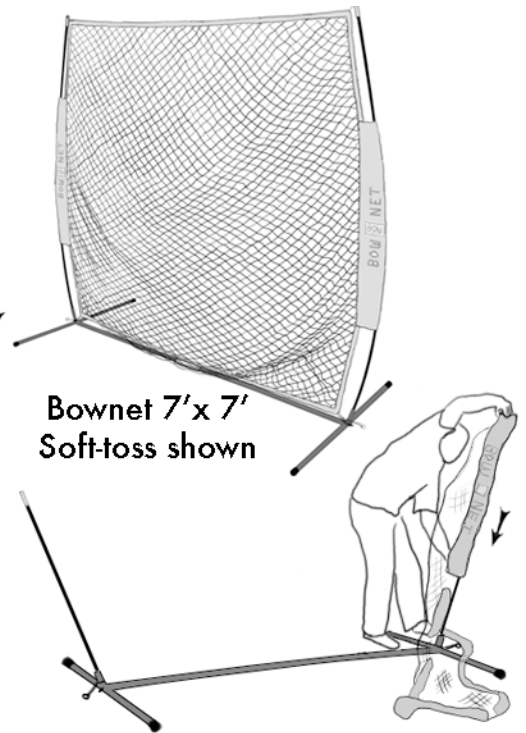

Warning

- To be used for restraining Soft/Base Balls only
- Not a toy, do not climb on net
- Must be used with adult supervision
- Must be either Staked or Weighted down using BowBags (not supplied)

Assembly Instructions for Soft-toss and Big Mouth Nets

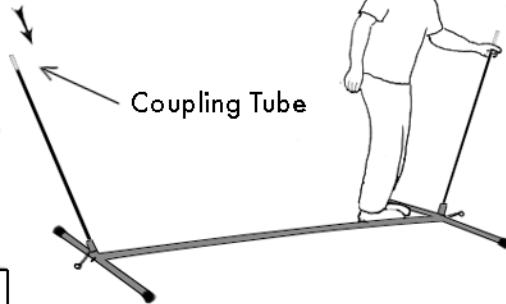
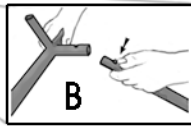
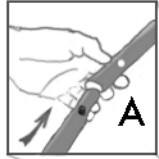

1. Join two straight Pipes together. Fig. A Then attach both end Legs. Fig. B

2. Install two lower Black Rods with Coupling Tubes up, in angled Pipes

3. Thread Orange sleeve over Black Rod. Make sure BowNet logo isn't up side down.

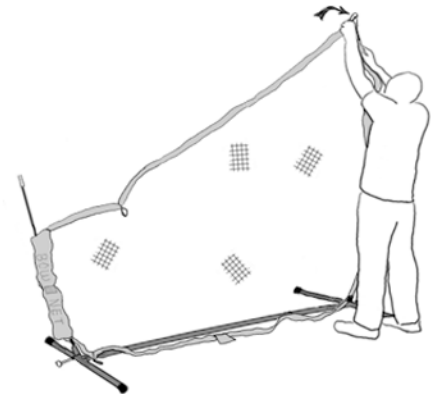
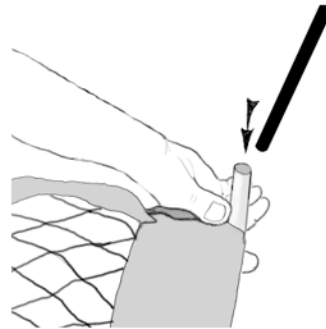
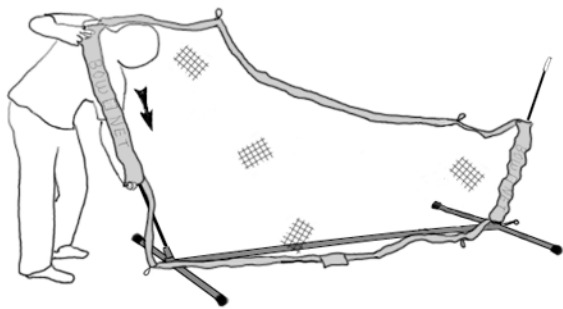

4. Repeat with Orange pocket over other Black Rod.

5. Take Black Rod and slot into lower Rod Coupling Tubes.

6. Hold Black Rod pulling Orange sleeve up and loop White Cord over rod top See #8.

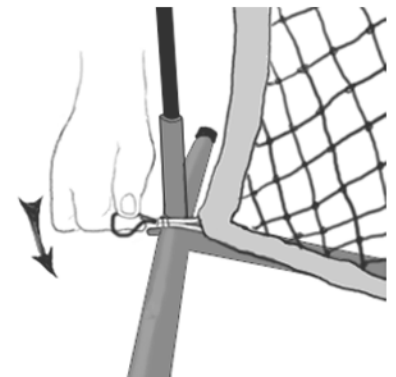
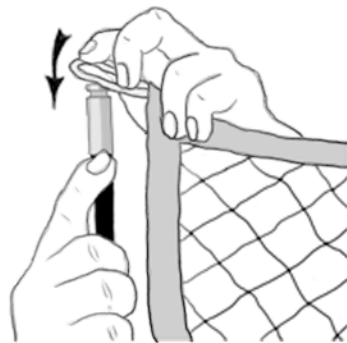
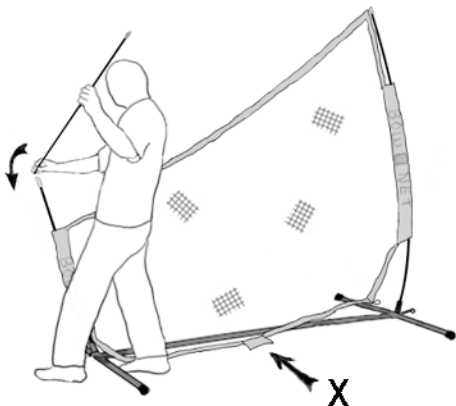

7. Take the last Black Rod and slot into Rod Coupling Tube.

8. Grip Black Rod pulling Orange sleeve up and loop Cord over Poll Top

9. Take lower Black elastic loops and place under stud on both end legs .

10. Wrap Velcro (X in Fig 7) around frame

1 year limited Manufactures Warranty on Manufacturing defects only. 30 day money back guarantee. For a full description of Warranty-Guarantee-Terms & Conditions. See www.thebownet.com

Triad Sports Group LLC. 360 Cortez Circle Camarillo, California 93012 866.950.NETS